

**Accommodating people
with Wernick Event Hire™**





Shower unit and ticket office, Showman's Show

The Oval • Sunningdale • Freeze Music Festival
 The Prince's Trust • Farnborough Air Show
 Hyde Park • London Marathon • Ryder Cup
 Notting Hill Carnival • Red Bull Air Race
 BBC Gardeners' World • Glastonbury Festival
 Althorp House • Chipping Sodbury Beer Festival



Offices and storage, Great North Run, Newcastle



Cabins for pit-stop, Goodwood Festival of Speed

A complete service for outdoor events, exhibitions, concerts, sporting fixtures and hospitality.

Wernick Event Hire provides a complete service for outdoor events, exhibitions, concerts, sporting fixtures and hospitality. People trust Wernick Event Hire to deliver everything from office accommodation, luxury toilets and showers, to ticket booths, steel storage and much more.

No other independent supplier can match our expertise, or the breadth of our hire fleet.

Wernick Event Hire can offer:

- Fully tailored packages for virtually any event location
- An expert service from depots nationwide
- Site surveys, advice and free quotation
- Accommodation and event equipment at short notice with fast delivery, installation and removal
- Service, maintenance, cleaning and emergency back-up
- Products and services which meet health and safety standards
- Flexible hire options
- Pre-event planning



Toilet units, Grand National, Aintree



Commentary box, Goodwood Festival of Speed

In what was an extremely difficult year, your team was very helpful and efficient, making an important contribution to the success of the event.

RHS Show, Tatton Park 2009

Best Accommodation

We offer an excellent range of accommodation options. Our jackleg units can be linked, or double-stacked, to create two-storey accommodation and our insurance-rated secure units give added protection against vandalism and theft.

No other independent supplier can match our expertise, or the breadth of our hire fleet.

Our range includes:

- Mains and non-mains toilets, washrooms and showers (gas and electric). Expert crews can carry out all cleaning and maintenance
- Disabled toilets, washrooms and shower blocks
- Ticket booths
- Offices, meeting rooms and changing rooms
- Choice of finishes and fixtures
- Secure stores



HM the Queen's 80th Birthday Celebrations, Buckingham Palace

“ Thank you for being part of the Children's Party at the Palace and making quite sure we pulled it off to the expected standard... I look forward to working with you again ”

Robbie Williams Productions, Party at the Palace & Princes Trust 2009



Offices for launch of cruise ship Queen Victoria, Southampton



Hospitality suite, Event Show, Olympia



Hospitality suite, Prince's Trust Concert, Kew Gardens

Best Service

As part of the Wernick Group of Companies, which is the largest independent supplier of portable and modular accommodation in Britain, you can be sure of the best possible accommodation for your event.

Our 24-hour support and maintenance cover provided by a nationwide network of local Wernick Hire depots can give you peace of mind that your event will be professionally supported by fully trained personnel.



Frocester Beer Festival
Belvoir Castle • Jaguar Fairs
National Trust Events
Tea In The Park • Big Chill
Uttoxeter Race Course
Oulton Park • Caravan Club
Swansea County Show
Mallory Park • The Belfry



The Prince's Trust 30th Birthday Concert, Tower of London

Yeovil Festival • Royal Windsor Horse Show
RAF Cosford • York Race Course • Godiva Festival
Chelmsford Beer Festival • Leeds Rock Festival
Woburn Oyster Festival • Atlantic Challenge
Essex Jamboree • Leicester Caribbean Carnival



Proven in the Field

Over the years, we have supported events at hundreds of different venues, including:

The Commonwealth Games, The Belfry, Mallory Park, National Trust Events, The Royal Windsor Horse Show, The Ryder Cup and Silverstone Grand Prix to name but a few well known venues and events.

We recognise that service excellence is key to our clients' expectations, not only before an event, but while the event is running and after it has closed.

A confirmed delivery date and experienced installation staff, hire period cleaning, rapid on-site repair, fast removal and emergency back up are all part of our hire package. Site visits are also carried out where we feel that this is advisable, or at a client's specific request.

Hundreds of our clients have tested our service in the field and proved that this level of service is all that we claim it to be. That is why they come back to us time and time again.



"I'd like to reiterate how pleased I was with the level of care and attention we received from the guys working on the project... nothing was too much trouble"

Tom Reed, Production Manager, Innovation - Red Bulls X-Fighters 2009



Toilets, Cancer Research UK Charity Run, Hyde Park



Toilets, PGA Championship



Demonstration suite, Showman's Show

Reasons to choose Wernick Event Hire

The Wernick Group is a leading developer of modular building techniques and has continued to expand and diversify since its modest beginnings in 1933. Now it is a national company offering a local service through its Hire Depots and Divisional Sales Offices.

- Fully trained employees
- Excellent value for money
- Experts in delivering excellent products and services on time, every time
- Fully tailored packages for virtually any requirement
- Fast delivery, service, maintenance, cleaning and emergency back-up
- Advice, site surveys where required and free quotations
- Hands-on local service backed by nationwide coverage
- Members of the following professional trade associations:
 - The Modular and Portable Buildings Association (MPBA)
 - National Outdoor Events Association (NOEA)
 - The Event Services Association (TESA)



Production offices and dressing rooms, Tower of London event

Reading Festival • Commonwealth Games
Silverstone Grand Prix • Isle of Wight Festival
Blenheim Palace • The Great Yorkshire Show
Military Odyssey • Atlantic Challenge

Cabins & Hospitality

Cabins - Our cabins are available in a wide range of sizes from 8' x 8' to 32' x 10'; as offices, ticket booths, stores, and anti-vandal units, sleeper units, event cabins and Citycabins™.

This wide range of cabins can be used at any type of event and non-specialized units can be adapted for many purposes, including security and catering.

Hospitality - Providing comfortable hospitality at an outdoor or indoor event is vital to continuing client relationships. Presenting your business in the right way reflects your company's professionalism.

Wernick Event Hire has a range of hospitality units that can meet your expectations and your pocket; from a compact entertainment area to a tiered unit with full kitchen, dining and relaxation areas. We can even include a viewing gallery to create the right impression at your event.

Typical layout of jackleg 24' x 9' Sleeper unit

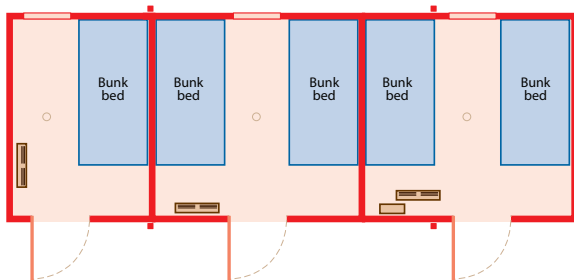

Typical layout of jackleg 24' x 10' Hospitality unit with kitchen

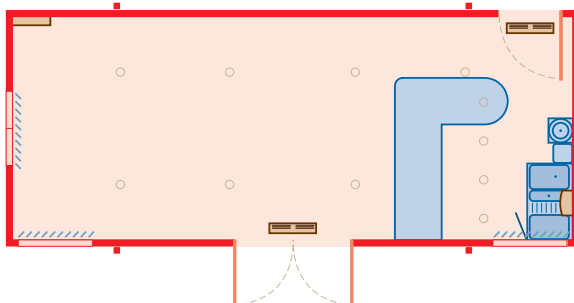

Organizer's offices, Goodwood Festival of Speed

- 8' x 8' 4-window ticket office (anti-vandal)
- 8' x 8' 4-window ticket office
- 10' x 8' Steel store
- 12' x 9' Citycabin™
- 12' x 10' 2-berth sleeper cabins
- 12' x 10' Cabin
- 16' x 8' Cabin (anti-vandal)
- 16' x 9' Citycabin™
- 16' x 10' Cabin
- 16' x 9' 3-window ticket booth
- 20' x 8' Store (anti-vandal)
- 20' x 9' Citycabin™
- 24' x 9' Cabin
- 24' x 9' Citycabin™
- 20' x 10' Event cabin c/w kitchenette
- 24' x 10' Cabin
- 24' x 9' 10-man sleeper cabin
- 24' x 10' Hospitality cabin
- 32' x 9' Citycabin™
- 32' x 10' Cabin
- 32' x 10' Cabin (anti-vandal)
- 32' x 10' Hospitality cabin

2-berth 'Lodja' Sleeper units complete with toilet and shower facilities



Interior view of 2-berth 'Lodja' unit



Toilets & Showers

We recognize that the standard of toilet and shower facilities offered at an event and the service that goes with these facilities can make or mar an event.

With this in mind our clients can choose from a wide range of units. You can select, or we can advise which type and how many units would be best for your event.

Our stock ranges from single chemical units to fully plumbed luxury blocks designed for mains connection. Our shower units can be electric or gas-powered and all our private facilities are available as self-contained mobile or jackleg units.

Ever conscious of the environment Wernick Event Hire's waterless urinal blocks can save around 40% water usage at an event, thus saving valuable natural resources and costs. Our experienced staff have the experience and expertise to offer accommodation solutions on all areas of your event that may save you money as well as protect the environment.

Typical layout of jackleg 24' x 10' male/female toilet unit (4 + 3)

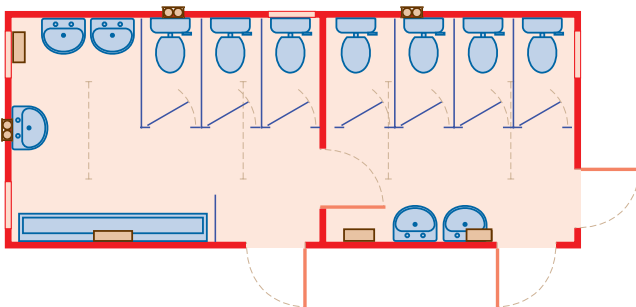

Typical layout of jackleg 24' x 10' male/female shower unit (3 + 3)

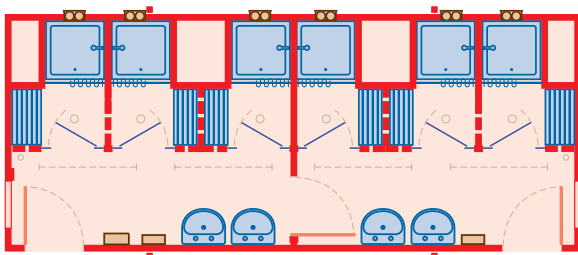

Typical layout of mobile gas-powered shower unit

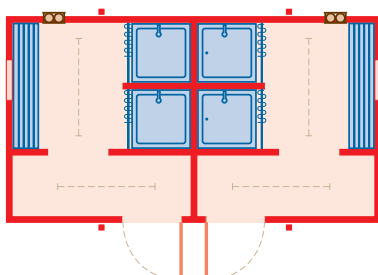

4 bay gas-powered mobile shower

- 7' x 5' Disabled mains jackleg toilets
- 10' x 7' Disabled mains toilet block (1 + 1)
- 8' x 8' Disabled mains toilet (anti-vandal)
- 10' x 10' Disabled toilet block c/w baby change
- 16' x 9' 4-bay mains toilet block
- 20' x 9' Urinal block (15 man)
- 20' x 10' Ladies/gents toilet block (3 + 2)
- 20' x 10' 7-bay ladies mains toilet block (anti-vandal)
- 20' x 10' 3-bay gents toilet block (anti-vandal)
- 20' x 10' 5-bay gents toilet block
- 22' x 9' 8-bay ladies toilet block
- 22' x 9' 8-bay gents toilet block
- 24' x 10' 7-bay ladies toilet block
- 24' x 10' Ladies/gents toilet block (4 + 3)
- 21' x 7' 6" Mobile mains toilet block
- 21' x 7' 6" Mobile re-circulating toilet block
- 4' x 4' Single plastic toilet units

Toilet facilities, Wentworth BMW Golf Championship



Mobile Units

Mobile accommodation units provide adaptable and convenient solutions for many types of event requirements. Available as general offices, but also as canteens, changing rooms, ticket offices and first-aid points, or as other bespoke accommodation solutions which we can customize the units for.

The mobility of these units allows rapid relocation by a 4 x 4 vehicle to locations that would be inaccessible by lorry. If ground conditions are soft, or poor weather conditions are forecast, these units offer the best solution. They can be delivered, set-up and then removed at the end of an event quickly and without fuss.



16' x 7' 6" mobile canteen



Rosslyn Park, National Schools Rugby 7's Tournament mobile changing room



Typical interior of mobile unit

Four standard sizes are available.

- 12' x 7' 6" Open plan office
- 16' x 7' 6" Open plan office
- 18' x 7' 6" Open plan office
- 20' x 7' 6" Open plan office

Typical layout of 12' x 7' 6" mobile unit

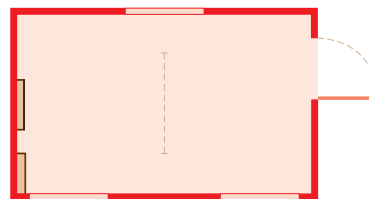

Typical layout of 20' x 7' 6" mobile unit

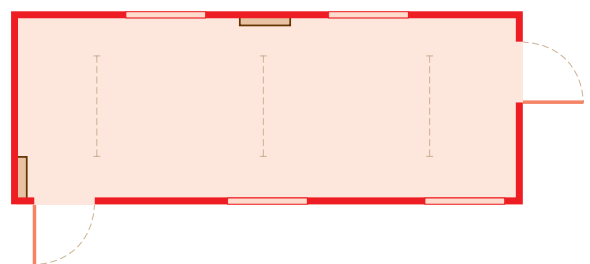

Glastonbury. 16' x 7' 6" mobile office

Hop Farm, Kent. 20' x 7' 6" mobile ticket office



Event Hire Depots

Birmingham

Joseph House
Northgate Way
Aldridge
Walsall
West Midlands WS9 8ST

Telephone: 01922 472900
Fax 01922 472910

London

Rivernook Farm
Terrace Road
Walton-on-Thames,
Surrey KT12 2ET

Telephone: 01932 565565
Fax 01932 232613

Winchester

Stockbridge Road
Sparsholt
Winchester
Hampshire SO21 2NA

Telephone: 01962 776527
Fax 01962 776569



For more information call

0845 601 4029

or go online at

www.wernickeventhire.co.uk



Wernick Event Hire Limited Head Office

Joseph House, Northgate Way, Aldridge,
Walsall, West Midlands WS9 8ST

Telephone: 01922 472900

Fax 01922 472910

email: sales@wernickevents.co.uk

www.wernickeventhire.co.uk



Part of the Wernick Group of Companies

The information supplied in this brochure is for guidance only. A detailed specification is supplied with our design quotation.

The information supplied in this brochure is for guidance only, detailed specification is supplied with our design quotation.

Supported by Wernick Hire Depots throughout Britain